

## Mini free-standing Beacons / LED-Permanent Light 201

### LED Perm. Beacon BM 24VAC/DC RD



Part No.: **201.100.75**



#### MECHANICAL DATA

|                              |                             |
|------------------------------|-----------------------------|
| Height                       | 81 mm                       |
| Diameter                     | 58 mm                       |
| Materials                    | PA-GF<br>PC                 |
| Dome colour                  | Red                         |
| Housing colour               | Black                       |
| Protection category          | IP65                        |
| Connection                   | Spring-type terminal        |
| cross-sectional area maximum | 2,50mm <sup>2</sup> / 14AWG |
| Cable entry                  | Through hole                |
| Cable entry maximum          | d = 10 mm                   |
| Type of fixing               | Base mounting               |
| Working temperature minimum  | -20°C                       |
| Working temperature maximum  | +50°C                       |
| Weight with packaging        | 85 g                        |
| Product weight               | 64 g                        |

#### ELECTRICAL DATA

|                             |                    |
|-----------------------------|--------------------|
| Operating voltage           | 24V                |
| Operating voltage type      | AC/DC              |
| Operating voltage frequency | 50Hz               |
| Operating voltage tolerance | +/- 10%            |
| Rated operational voltage   | 24 VDC             |
| Rated operational current   | 45 mA              |
| Rated inrush current        | 500 mA             |
| Protection class            | Protection class 2 |
| Pollution degree            | 3                  |

#### OPTICAL DATA

|                      |                   |
|----------------------|-------------------|
| Light source         | LED               |
| Light colour         | Red               |
| Optical signal image | Permanent         |
| Service life optical | 100,000 h maximum |

#### APPROVAL DATA

|                              |     |
|------------------------------|-----|
| Conforms with CE             | Yes |
| Conforms with RoHS directive | Yes |
| WEEE                         | Yes |
| Conforms with ATEX-directive | No  |



For additional installation and mounting information, refer to the appropriate user guide at [www.werma.com](http://www.werma.com). This printed copy is for information only and is subject to alteration.

Mini free-standing Beacons / LED-Permanent Light 201

**LED Perm. Beacon BM 24VAC/DC RD**

|                               |                       |
|-------------------------------|-----------------------|
| Conforms with CCC             | No                    |
| Conforms with UL              | cULus                 |
| UL Type Rating                | Type 12               |
| Conforms with FCC             | No                    |
| Conforms with IC              | No                    |
| EAC certificate available     | Yes                   |
| Conforms with UKCA (Importer) | Yes (WERMA (UK) Ltd.) |
| Conforms with AS-I            | No                    |
| ICAO Certification            | No                    |
| Conforms with DNV             | No                    |
| Conforms with RoHS CN         | No                    |
| Conforms with VdS             | No                    |
| MTTF-value [years]            | 6939                  |

**DRAWING**

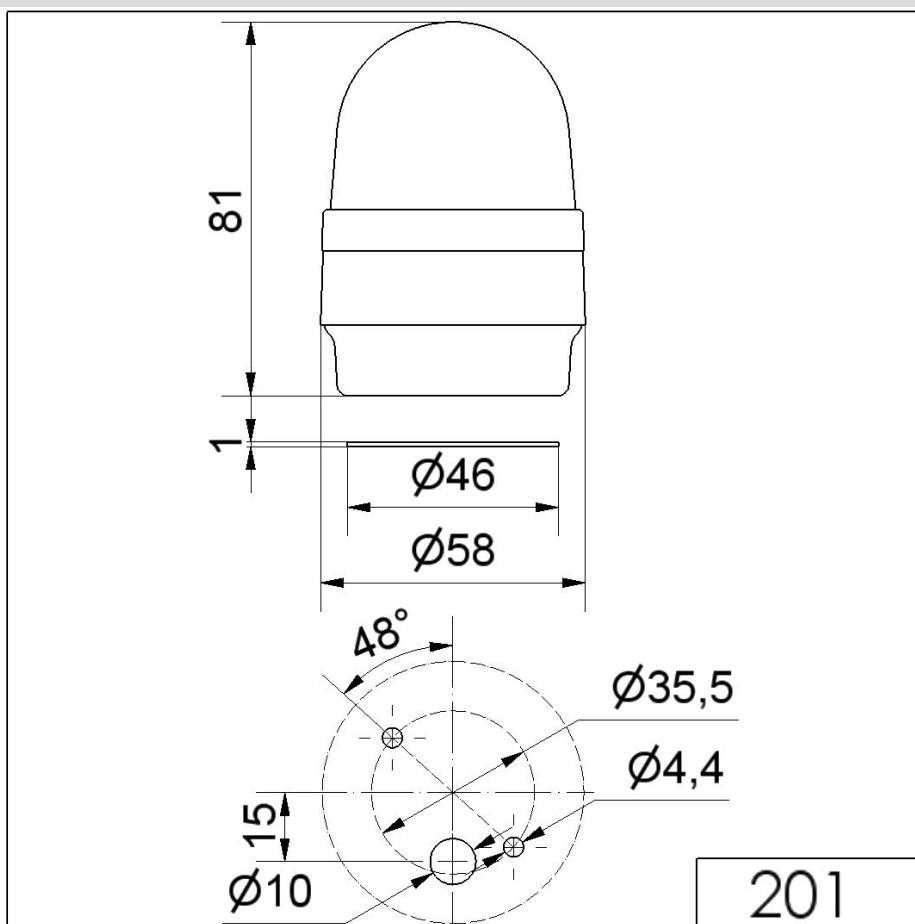

For additional installation and mounting information, refer to the appropriate user guide at [www.werma.com](http://www.werma.com). This printed copy is for information only and is subject to alteration.